

Socket Welding Flanges - ANSI B16.5

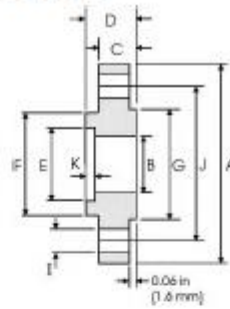

Class 150 lb

Nominal Pipe Size	Pipe	Flange						Hub	Raised Face	Drilling Data			Weight
		A	B	C	D	E	K	F	G	H	I	J	
	Outside Diameter	Overall Diameter	Inside Diameter	Flange Thickness min	Overall Length	Socket Diameter	Depth of Socket	Hub Diameter	Face Diameter	No. of Holes	Bot Hole Diameter	Diameter of Circle of Holes	kg/ piece
in mm	in mm	in mm	in mm	in mm	in mm	in mm	in mm	in mm	in mm		in mm	in mm	
1/2	0.840	3.500	0.620	0.440	0.620	0.880	0.380	1.190	1.380		0.620	2.380	0.42
	21.30	88.90	15.70	11.20	15.70	22.40	9.600	30.20	35.10		15.70	60.45	
3/4	1.050	3.890	0.820	0.500	0.620	1.050	0.440	1.500	1.690		0.620	2.750	0.59
	26.70	98.90	20.80	12.70	15.70	27.00	11.40	38.40	42.90	4	15.70	69.85	
1	1.315	4.250	1.050	0.560	0.690	1.360	0.500	1.940	2.000		0.620	3.120	0.81
	33.40	108.0	26.70	14.20	17.50	34.50	12.70	49.30	50.80	4	15.70	79.25	
1 1/4	1.660	4.620	1.380	0.620	0.810	1.700	0.560	2.310	2.500		0.620	3.500	1.07
	42.20	117.3	35.10	15.70	20.60	43.20	14.20	58.70	63.50	4	15.70	88.90	
1 1/2	1.900	5.000	1.610	0.690	0.880	1.950	0.620	2.560	2.880		0.620	3.880	1.36
	48.30	127.0	40.90	17.50	22.30	49.50	15.70	65.00	73.15	4	15.70	98.60	
2	2.375	6.000	2.070	0.750	1.000	2.440	0.690	3.060	3.620		0.750	4.750	2.10
	60.30	152.4	52.60	19.10	25.40	62.00	17.50	77.70	91.80	4	19.10	120.7	
2 1/2	2.875	7.000	2.470	0.880	1.120	2.940	0.750	3.560	4.120		0.750	5.500	3.33
	73.00	177.8	62.70	22.40	28.40	74.70	19.00	90.40	104.6	4	19.10	139.7	
3	3.500	7.500	3.070	0.940	1.190	3.570	0.810	4.250	5.000		0.750	6.000	3.90
	88.90	190.5	78.00	23.90	30.20	90.70	20.60	108.0	127.0	4	19.10	152.4	

Class 300 lb

Nominal Pipe Size	Pipe	Flange						Hub	Raised Face	Drilling Data			Weight
		A	B	C	D	E	K	F	G	H	I	J	
	Outside Diameter	Overall Diameter	Inside Diameter	Flange Thickness min	Overall Length	Socket Diameter	Depth of Socket	Hub Diameter	Face Diameter	No. of Holes	Bot Hole Diameter	Diameter of Circle of Holes	kg/ piece
in mm	in mm	in mm	in mm	in mm	in mm	in mm	in mm	in mm	in mm		in mm	in mm	
1/2	0.840	3.750	0.620	0.560	0.880	0.880	0.380	1.500	1.380		0.620	2.520	0.66
	21.30	95.20	15.70	14.20	22.30	22.40	9.600	38.10	35.10	4	15.70	64.55	
3/4	1.050	4.620	0.820	0.620	1.000	1.090	0.440	1.880	1.890		0.750	3.250	1.15
	26.70	117.3	20.80	15.70	25.40	27.70	11.10	47.70	42.90	4	19.10	82.50	
1	1.315	4.880	1.050	0.690	1.060	1.360	0.500	2.120	2.000		0.750	3.500	1.40
	33.40	123.9	26.70	17.50	26.90	34.50	12.70	53.80	50.80	4	19.10	88.90	
1 1/4	1.660	5.250	1.380	0.750	1.060	1.700	0.560	2.300	2.500		0.750	3.880	1.75
	42.20	133.3	35.10	19.00	26.90	43.20	14.20	63.50	63.50	4	19.10	98.60	
1 1/2	1.900	6.120	1.610	0.810	1.190	1.950	0.620	2.750	2.880		0.880	4.500	2.55
	48.30	155.4	40.90	20.60	30.20	49.50	15.70	69.85	73.15	4	22.30	114.3	
2	2.375	6.500	2.070	0.880	1.310	2.440	0.690	3.310	3.620		0.750	5.000	2.93
	60.30	165.1	52.60	22.30	33.20	62.00	17.50	84.00	91.80	8	19.10	127.0	
2 1/2	2.875	7.500	2.470	1.000	1.500	2.940	0.750	3.940	4.120		0.880	5.880	4.40
	73.00	190.5	62.70	25.40	38.10	74.70	19.00	100.0	104.6	8	22.30	149.3	
3	3.500	8.250	3.070	1.120	1.690	3.570	0.810	4.620	5.000		0.880	6.520	5.92
	88.90	209.5	78.00	28.40	42.90	90.70	20.60	117.3	127.0	8	22.30	165.1	

Notes

- Dimension B corresponds to the pipe inside diameter. Values quoted assume 40G/Standard wall thickness.
- Weights are based on manufacturer's data and are approximate.
- For ring joint facings see page 8-6. For tolerances see page 8-4.

Socket Welding Flanges - ANSI B16.5

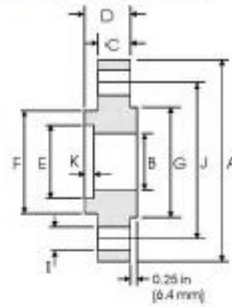

Class 600 lb

Nominal Pipe Size	Pipe		Flange					Hub	Raised Face	Drilling Data			Weight
	A	B	C	D	E	K	F	G	H	I	J	kg/ piece	
	Outside Diameter	Overall Diameter	Inside Diameter	Flange Thickness	Overall Length	Socket Diameter	Depth of Socket	Hub Diameter	Face Diameter	No. of Holes	Bolt Hole Diameter		Diameter of Circle of Holes
in mm	in mm	in mm	in mm	in mm	in mm	in mm	in mm	in mm	in mm		in mm	in mm	
1/2	0.840	3.750	To be specified by the Purchaser	0.560	0.880	0.880	0.380	1.500	1.380	4	0.620	2.620	0.76
	21.30	95.30		14.20	22.30	22.40	9.600	38.10	35.10		16.70	66.60	
3/4	1.050	4.520		0.520	1.000	1.090	0.440	1.890	1.690	4	0.750	3.250	1.29
	26.70	117.3		13.20	25.40	27.70	11.10	47.70	42.90		19.10	82.50	
1	1.315	4.880		0.590	1.060	1.360	0.500	2.120	2.000	4	0.750	3.900	1.55
	33.40	123.9		17.50	26.90	34.50	12.70	53.80	50.80		19.10	88.90	
1 1/4	1.660	5.250		0.810	1.120	1.700	0.560	2.500	2.500	4	0.750	3.880	2.06
	42.20	133.3		20.60	28.40	43.20	14.20	63.50	63.50		19.10	88.60	
1 1/2	1.900	6.120		0.880	1.250	1.950	0.620	2.750	2.880	4	0.880	4.500	3.00
	48.30	155.4		22.30	31.75	49.50	15.70	69.85	73.15		22.30	114.3	
2	2.375	6.500		1.000	1.440	2.440	0.690	3.310	3.620	8	0.750	5.000	3.67
	60.30	165.1		25.40	36.50	62.00	17.50	84.00	91.90		19.10	127.0	
2 1/2	2.875	7.500	1.120	1.620	2.940	0.750	3.940	4.120	8	0.880	5.880	5.35	
	73.00	190.5	28.40	41.10	74.70	19.00	100.0	104.6		22.30	149.3		
3	3.500	8.250	1.250	1.810	3.570	0.810	4.620	5.000	8	0.880	6.620	7.06	
	88.90	209.5	31.75	45.00	90.70	20.60	117.2	127.0		22.30	169.1		

Class 1500 lb

Nominal Pipe Size	Pipe		Flange					Hub	Raised Face	Drilling Data			Weight
	A	B	C	D	E	K	F	G	H	I	J	kg/ piece	
	Outside Diameter	Overall Diameter	Inside Diameter	Flange Thickness	Overall Length	Socket Diameter	Depth of Socket	Hub Diameter	Face Diameter	No. of Holes	Bolt Hole Diameter		Diameter of Circle of Holes
in mm	in mm	in mm	in mm	in mm	in mm	in mm	in mm	in mm	in mm		in mm	in mm	
1/2	0.840	4.750	To be specified by the Purchaser	0.880	1.250	0.880	0.380	1.500	1.380	4	0.880	3.250	1.80
	21.30	120.6		22.30	31.70	22.40	9.600	38.10	35.10		22.30	82.50	
3/4	1.050	5.120		1.000	1.380	1.090	0.440	1.750	1.690	4	0.880	3.500	2.41
	26.70	130.0		25.40	35.00	27.70	11.10	44.40	42.90		22.30	88.90	
1	1.315	5.880		1.120	1.620	1.360	0.500	2.060	2.000	4	1.000	4.000	3.55
	33.40	149.3		28.40	41.10	34.50	12.70	52.30	50.80		25.40	101.6	
1 1/4	1.660	6.250		1.120	1.620	1.700	0.560	2.500	2.500	4	1.000	4.380	4.02
	42.20	158.7		28.40	41.10	43.20	14.20	63.50	63.50		25.40	111.2	
1 1/2	1.900	7.000		1.250	1.750	1.950	0.620	2.750	2.880	4	1.120	4.880	5.45
	48.30	177.8		31.75	44.50	49.50	15.70	69.85	73.15		28.40	123.9	
2	2.375	8.500		1.500	2.250	2.440	0.690	4.120	3.620	8	1.000	6.500	10.2
	60.30	215.9		38.10	57.15	62.00	17.50	104.6	91.90		25.40	165.1	
2 1/2	2.875	9.520	1.620	2.500	2.940	0.750	4.880	4.120	8	1.120	7.500	13.9	
	73.00	244.3	41.10	63.50	74.70	19.00	123.9	104.6		28.40	190.5		

Notes

- Class 400 socket weld flanges may be provided in NPS 1/2 to 2 1/2 using Class 600 dimensions
- Dimension B corresponds to the pipe inside diameter. Values quoted assume 400G/standard wall thickness.
- Weights are based on manufacturer's data and are approximate.
- For ring joint facings see page 8-6. For tolerances see page 8-4.

Tianjin All Best International Trade Co., Ltd is a famous provider of steel pipe fittings.

Our business involves Oil & Gas Industry, Mining Industry, Automobile Industry, Chemical Industry and Construction Industry.

Our products include elbow, flange, reducer, pipe cap, tee and corrugated expansion joint and seamless steel line pipe. We have got good recognition from our customers in South America, South East Asia and North Africa.

These pipe fittings can be made according to both GB and International standards, ASME, DIN, BS, JIS & GOST. In the last years, we got API 5L, and API Q1 international certification for the products. ISO9001, ISO14001, and OHAS18001 are three basic certificates for our quality, service, environment and workers' qualification.

Our factory covers an area of 70000 square meters in Xiwang New District, Mengcun County, Cangzhou, Hebei, China. With advanced equipment, excellent management, skilled workers, and ambitious salesmen, we have great confidence to provide you with better products with the most reasonable price. To win customers's belief in us is the goal for the whole company for ever.

Welcome you to visit us in China or send emails to us. We love friends and like the reply buttons.

Contact us:

Litas Lee,

Mobile/WhatsApp/Viber: [8615522509091](tel:8615522509091)

Telephone: 02287802560

Fax: 02287808131

E-mail: Sale01@tianjin-all-best.com

Skype: [Litas.Lee520](https://www.skype.com/user/Litas.Lee520)

QQ: 482171537

Tianjin All Best International Trade Co., Ltd

Website: www.tianjin-all-best.com

Marketing Department: 7th Floor, Block 36#, Sunny Plaza, Huanghe Road, Nankai,

Tianjin, China

Factory: Xiwang New District, Mengcun, Cangzhou, hebei, China