

**GM20-130SH** 20mm gearbox plus 130&180 permanent magnet DC motor

- Small size dc gear motor with low speed and big torque
- 20mm gear motor provide 0.3Nm torque and more reliable
- Suitable to small diameter. Low noise and big torque application
- Dc gear motors can match encoder,3ppr
- Reduction ratio: 29、31、56、73、107、140、182、195、268、349、456、488

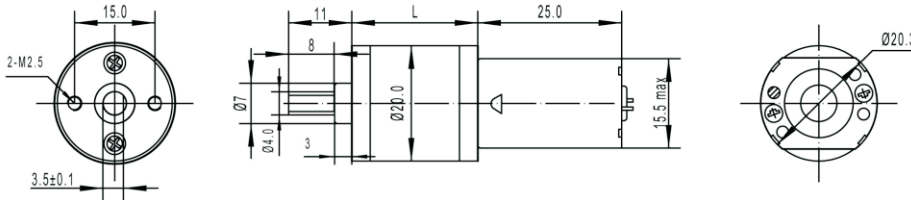

Gear Motor Dimensions (mm)

**Motor Technical Data**

Motor model No.	Rated voltage	No-load speed	No-load current	Rated speed	Rated torque	Rated current	Output power	Stall torque	Stall current
	VDC	r/min	mA	r/min	g.cm	mA	W	g.cm	A
<b>TFF-130SH-14230</b>	6.0	7200	50	5600	15	255	0.87	65	1.10
<b>TFF-130SH-11340</b>	6.0	4800	30	3600	10	140	0.38	43	0.50
<b>TFF-130SH-11370</b>	12.0	8800	40	6900	15	170	1.10	70	0.70

**Gear Motor Technical Data**

Gearbox with motor: GM20-130SH-14230-XXX

	29	31	56	73	107	182	268	349	456	488
<b>Reduction ratio</b>	29	31	56	73	107	182	268	349	456	488
<b>Length mm</b>	15.9	15.9	17.4	17.4	18.9	18.9	20.4	20.4	20.4	20.4
<b>No-load speed rpm</b>	240	220	220	95	65	40	27	21	16	15
<b>Rated speed rpm</b>	190	180	100	76	52	31	21	16	13	12
<b>Rated torque kg.cm</b>	0.3	0.3	0.5	0.7	0.9	1.5	2.0	2.6	3.0	3.0
<b>Max.momentary tolerance torque kg.cm</b>	1.3	1.4	2.2	2.8	3.8	5.0	5.0	5.0	5.0	5.0

**Gearbox with motor**

GM20-130SH-11340-XXX

	29	31	56	73	107	182	268	349	456	488
<b>Reduction ratio</b>	29	31	56	73	107	182	268	349	456	488
<b>Length mm</b>	15.9	15.9	17.4	17.4	18.9	18.9	20.4	20.4	20.4	20.4
<b>No-load speed rpm</b>	155	145	80	62	42	25	17	13	10	9
<b>Rated speed rpm</b>	131	123	68	52	36	21	14	11	8	8
<b>Rated torque kg.cm</b>	0.14	0.16	0.3	0.4	0.5	0.9	1.3	1.5	1.9	2.1
<b>Max.momentary tolerance torque kg.cm</b>	0.75	0.8	1.4	1.9	2.7	4.0	5.0	5.0	5.0	5.0

**Gearbox with motor**

GM20-130SH-11370-XXX

	29	31	56	73	107	182	268	349	456	488
<b>Reduction ratio</b>	29	31	56	73	107	182	268	349	456	488
<b>Length mm</b>	15.9	15.9	17.4	17.4	18.9	18.9	20.4	20.4	20.4	20.4
<b>No-load speed rpm</b>	290	270	150	115	80	48	33	25	19	18
<b>Rated speed rpm</b>	235	220	120	95	65	38	26	20	16	15
<b>Rated torque kg.cm</b>	0.3	0.3	0.3	0.7	0.9	1.5	2.0	2.6	3.0	3.0
<b>Max.momentary tolerance torque kg.cm</b>	1.4	1.5	2.3	3.1	4.1	5.0	5.0	5.0	5.0	5.0