

Dimensions in "mm"

Capacity/KN	120	180	220	260	330	400	500
C	48	60	66	72	29	90	100
D	17	22	24	26	29	32	36

Wiring Diagram/接线图

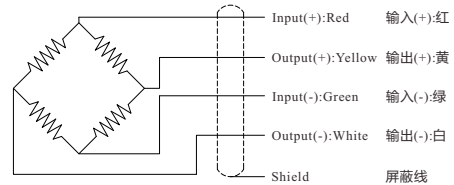

--- Specifications / 规格参数 ---

Capacity/量程	120/180/220/260/330/400/500KN		
Rated Output 额定输出	2.0±10% mV/V	Compensated Temp. 温度补偿范围	-10...+40°C
Excitation 激励电压	5~15V	Operating Temp. 工作温度范围	-20...+60°C
Zero Balance 零点输出	±2% of R.O.	Temp. Shift Zero 零点温度漂移	±0.01% of R.O./°C
Nonlinearity 非线性	±0.5% of R.O.	Temp. Shift Span 灵敏度温度漂移	±0.01% of R.O./°C
Hysteresis 滞后	±0.5% of R.O.	Input Resistance 输入阻抗	730±50Ω
Nonrepeatability 非重复性	±0.1% of R.O.	Output Resistance 输出阻抗	700±10Ω
Creep(30min) 蠕变	±0.1% of R.O.	Insulation Resistance 绝缘阻抗	>2000MΩ(50V)
Safe Overload 安全过载	150% of F.S.	Ingress Protection 防护等级	IP62
Ultimate Overload 极限过载	200% of F.S.	Material of Element 弹性体材料	Alloy steel 合金钢
Cable 导线	Ø4.8*2000mm 4-core shielded cable(Longer cable available) Ø4.8*2000mm 4芯屏蔽线		
R.O.=Rated Output/额定输出 F.S.=Full Scale/满量程			

• Subject to change without notice / 如有更改,不另行通知

Through hole load cell custom table

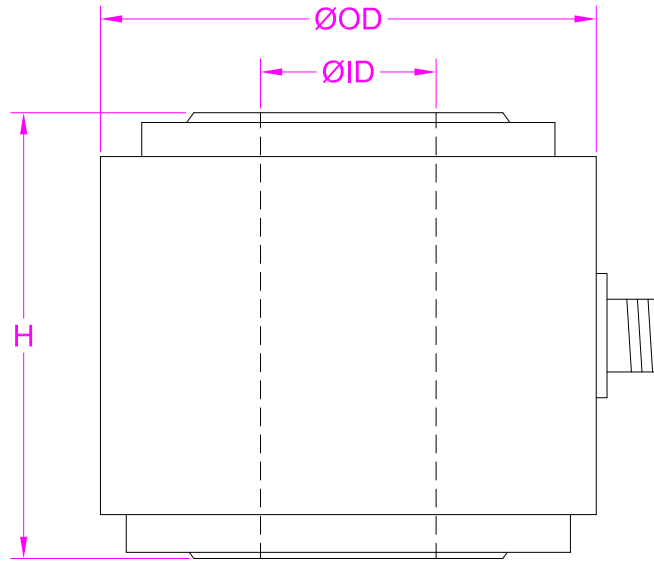

Capacity(KN)	
ID(mm)	
OD(mm)	
H(mm)	
Material	
Working temp.	
Ingress protection	
Cable length	
Desired accuracy	
Quantity(pcs)	
Other requirements	