

Threaded Flanges - ANSI B16.5

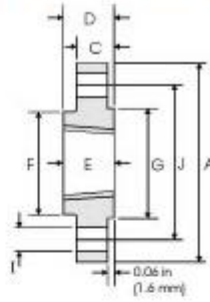

Class 150 lb

Nominal Pipe Size	Pipe		Flange Data					Hub	Raised Face	Drilling Data			Weight
			A	C	D	E	F	G	H	I	J		
	Outside Diameter	Overall Diameter	Flange Thickness	Overall Length	Threaded length	Hub Diameter	Face Diameter	Number of Holes	Bolt Hole Diameter	Diameter of Circle of Holes	kg/ piece		
1/2	0.840	3.500	0.440	0.620	0.620	1.190	1.380	4	0.620	2.380	0.39		
	21.30	88.90	11.20	15.70	15.70	30.20	35.10		15.70	60.45			
3/4	1.050	3.880	0.500	0.620	0.620	1.500	1.690	4	0.620	2.750	0.56		
	26.70	98.60	12.70	15.70	15.70	38.10	42.90		15.70	69.85			
1	1.315	4.250	0.560	0.690	0.690	1.940	2.000	4	0.620	3.120	0.78		
	33.40	108.0	14.20	17.50	17.50	49.30	50.80		15.70	79.25			
1 1/4	1.660	4.620	0.620	0.810	0.810	2.310	2.500	4	0.620	3.500	1.03		
	42.20	117.3	15.70	20.50	20.50	58.70	63.50		15.70	88.90			
1 1/2	1.900	5.000	0.690	0.880	0.880	2.650	2.880	4	0.620	3.880	1.32		
	48.30	127.0	17.50	22.40	22.40	65.00	73.15		15.70	98.60			
2	2.375	6.000	0.750	1.000	1.000	3.050	3.520	4	0.750	4.750	2.06		
	60.30	152.4	19.10	25.40	25.40	77.70	91.90		19.10	120.7			
2 1/2	2.875	7.000	0.880	1.120	1.120	3.560	4.120	4	0.750	5.500	3.28		
	73.00	177.8	22.40	28.40	28.40	90.40	104.6		19.10	139.7			
3	3.500	7.500	0.940	1.190	1.190	4.250	5.000	4	0.750	6.000	3.85		
	88.90	190.5	23.80	30.20	30.20	108.0	127.0		19.10	152.4			
3 1/2	4.000	8.500	0.940	1.250	1.250	4.810	5.500	8	0.750	7.000	4.81		
	101.6	215.9	23.80	31.75	31.75	122.2	139.7		19.10	177.8			
4	4.500	9.000	0.940	1.310	1.310	5.310	6.190	8	0.750	7.500	5.30		
	114.3	229.6	23.80	33.30	33.30	134.9	157.2		19.10	190.5			
5	5.563	10.000	0.940	1.440	1.440	6.440	7.310	8	0.880	8.500	6.07		
	141.3	254.0	23.90	36.60	36.60	163.6	185.7		22.40	215.9			
6	6.625	11.000	1.000	1.560	1.560	7.560	8.500	8	0.880	9.500	7.45		
	168.3	279.4	25.40	39.60	39.60	192.0	215.9		22.40	241.3			
8	8.625	13.500	1.120	1.750	1.750	9.690	10.62	8	0.880	11.75	12.1		
	219.1	342.9	28.40	44.50	44.50	246.1	269.7		22.40	298.5			
10	10.75	16.000	1.190	1.940	1.940	12.000	12.75	12	1.000	14.25	16.5		
	273.0	406.4	30.20	49.30	49.30	304.8	323.9		25.40	362.0			
12	12.75	19.000	1.250	2.190	2.190	14.38	15.00	12	1.000	17.00	26.2		
	323.8	482.6	31.75	55.60	55.60	365.3	381.0		25.40	431.8			
14	14.00	21.000	1.380	2.250	2.250	15.75	16.25	12	1.120	18.75	34.6		
	355.6	533.4	35.10	57.15	57.15	400.1	412.7		28.40	476.3			
16	16.00	23.500	1.440	2.500	2.500	18.000	18.50	16	1.120	21.25	44.8		
	406.4	596.9	36.60	63.50	63.50	457.2	469.9		28.40	539.8			
18	18.00	26.000	1.560	2.690	2.690	19.88	21.00	16	1.250	22.75	48.9		
	457.2	635.0	39.60	68.30	68.30	505.0	533.4		31.75	577.9			
20	20.00	27.500	1.690	2.880	2.880	22.000	23.00	20	1.250	25.00	61.9		
	508.0	698.5	42.90	73.15	73.15	558.8	584.2		31.75	635.0			
24	24.00	32.000	1.880	3.250	3.250	26.12	27.25	20	1.380	29.50	86.9		
	609.6	812.8	47.80	82.60	82.60	663.4	692.2		35.10	745.3			

Notes

- The thread conforms to ASME B1.20.1 NTP threads as described in Section 10. (The only exceptions are small male and female plain face threaded flanges which use NPSL recount threads.)
- Class 150 threaded flanges are made without a counterbore. Threads are chamfered to the major diameter (approx.) at an angle of 45° (approx.) at the back of the flange.
- Weights are based on manufacturer's data and are approximate.
- For tolerances see page 8-4.

Threaded Flanges - ANSI B16.5

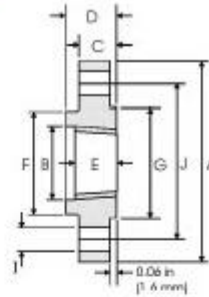

Class 300 lb

Nominal Pipe Size	Pipe		Flange Data					Hub	Face	Drilling Data			Weight
	A	B	C	D	E	F	G	H	I	J			
	Outside Diameter	Overall Diameter	Counter-bore min	Flange Thickness min	Overall Length	Threaded length min	Hub Diameter	Face Diameter	Number of Holes	Bolt Hole Diameter	Diameter of Circle of Holes	kg/ piece	
1/2	0.840	3.750	0.930	0.560	0.880	0.620	1.500	1.380	4	0.620	2.620	0.64	
	21.30	95.20	23.60	14.20	22.30	15.70	38.10	35.00		15.70	66.55		
3/4	1.050	4.620	1.140	0.620	1.000	0.620	1.880	1.690	4	0.750	3.250	1.12	
	26.70	117.3	29.00	15.70	25.40	15.70	47.70	42.90		19.00	82.50		
1	1.315	4.880	1.410	0.690	1.060	0.690	2.120	2.000	4	0.750	3.500	1.36	
	33.40	123.9	35.80	17.50	26.90	17.50	53.80	50.80		19.00	88.90		
1 1/4	1.860	5.250	1.750	0.750	1.060	0.810	2.500	2.500	4	0.750	3.880	1.68	
	42.20	133.3	44.40	19.00	26.90	20.60	63.50	63.50		19.00	99.50		
1 1/2	1.900	6.120	1.980	0.810	1.190	0.880	2.750	2.880	4	0.880	4.500	2.49	
	48.30	155.4	50.50	20.50	30.20	22.30	69.85	73.15		22.30	114.3		
2	2.375	6.500	2.500	0.880	1.310	1.120	3.310	3.620	8	0.750	5.000	2.87	
	60.30	165.1	63.50	22.30	33.20	28.40	84.00	91.90		19.00	127.0		
2 1/2	2.875	7.500	3.000	1.000	1.500	1.250	3.940	4.120	8	0.880	5.880	4.32	
	73.00	190.5	76.20	25.40	38.10	31.70	100.0	104.6		22.30	149.3		
3	3.500	8.250	3.630	1.120	1.690	1.250	4.620	5.000	8	0.880	6.620	5.85	
	88.90	209.5	92.20	28.40	42.90	31.70	117.3	127.0		22.30	168.1		
3 1/2	4.000	9.000	4.130	1.190	1.750	1.440	5.250	5.500	8	0.880	7.250	7.34	
	101.6	228.6	104.9	30.20	44.40	36.50	133.3	139.7		22.30	184.1		
4	4.500	10.00	4.630	1.250	1.880	1.440	5.750	6.190	8	0.880	7.880	9.61	
	114.3	254.0	117.6	31.70	47.70	36.50	146.0	157.2		22.30	200.1		
5	5.563	11.00	5.690	1.380	2.000	1.690	7.000	7.310	8	0.880	9.250	12.3	
	141.3	279.4	144.5	35.00	50.80	42.90	177.8	185.7		22.30	234.9		
6	6.525	12.50	6.750	1.440	2.060	1.810	8.120	8.500	12	0.880	10.52	15.6	
	168.3	317.5	171.4	36.50	52.30	45.90	205.2	215.9		22.30	269.7		
8	8.625	15.00	8.750	1.620	2.440	2.000	10.25	10.62	12	1.000	13.00	24.2	
	219.1	381.0	222.2	41.10	61.90	50.80	260.3	269.7		25.40	330.2		
10	10.75	17.50	10.88	1.880	2.620	2.190	12.62	12.75	16	1.120	15.25	34.1	
	273.0	444.5	276.3	47.70	66.55	55.60	320.5	323.9		28.40	387.3		
12	12.75	20.50	12.94	2.000	2.880	2.380	14.75	15.00	16	1.250	17.75	49.8	
	323.8	520.7	328.7	50.80	73.15	60.45	374.6	381.0		31.70	450.8		
14	14.00	23.00	14.19	2.120	3.000	2.500	16.75	16.25	20	1.250	20.25	69.9	
	355.6	584.2	360.4	53.80	76.20	63.50	425.4	412.7		31.70	514.3		
16	16.00	25.50	16.19	2.250	3.250	2.690	19.00	18.50	20	1.380	22.50	88.1	
	406.4	647.7	411.7	57.15	82.50	68.30	482.6	469.9		35.00	571.5		
18	18.00	28.00	18.19	2.380	3.500	2.750	21.00	21.00	24	1.380	24.75	109	
	457.2	711.2	462.0	60.45	88.90	69.85	533.4	533.4		35.00	628.6		
20	20.00	30.50	20.19	2.500	3.750	2.880	23.12	23.00	24	1.380	27.00	134	
	508.0	774.7	512.8	63.50	95.2	73.15	587.2	584.2		35.00	685.8		
24	24.00	36.00	24.19	2.750	4.190	3.250	27.62	27.25	24	1.620	32.00	201	
	609.6	914.4	614.4	69.85	106.4	82.50	701.5	692.2		41.10	812.8		

Notes

- The thread conforms to ASME B1.20.1 NTP threads as described in Section 10. (The only exceptions are small male and female plain face threaded flanges which use NPQL locknut threads.)
- Class 300 and higher threaded flanges are counter-bored. Threads are chamfered to the counterbore at an angle of 45° (approx).
- Weights are based on manufacturer's data and are approximate.
- For tolerances see page 8-4.

Threaded Flanges - ANSI B16.5

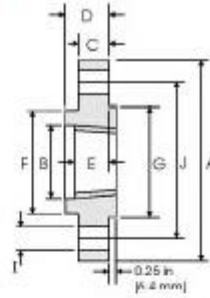

Class 400 lb

Nominal Pipe Size	Pipe	Flange Data					Hub	Raised Face	Drilling Data			Weight
		A	B	C	D	E	F	G	H	I	J	
	Outside Diameter in mm	Overall Diameter in mm	Counter-bore in mm	Flange Thickness in mm	Overall Length in mm	Threaded length in mm	Hub Diameter in mm	Face Diameter in mm	Number of Holes	Bolt Hole Diameter in mm	Diameter of Circle of Holes in mm	kg/ piece
1/2	0.840	3.750	0.930	0.560	0.880	0.620	1.500	1.380	4	0.620	2.620	0.74
	21.30	95.30	23.60	14.20	22.40	15.70	38.10	35.10		15.70	66.65	
3/4	1.050	4.620	1.140	0.620	1.000	0.620	1.880	1.690	4	0.750	3.250	1.27
	26.70	117.3	29.00	15.70	25.40	15.70	47.80	42.90		19.10	82.60	
1	1.315	4.880	1.410	0.690	1.060	0.690	2.120	2.000	4	0.750	3.500	1.52
	33.40	124.0	35.80	17.50	26.90	17.50	53.80	50.80		19.10	88.90	
1 1/4	1.660	5.250	1.750	0.810	1.120	0.810	2.500	2.500	4	0.750	3.880	2.03
	42.20	133.4	44.50	20.60	28.40	20.60	63.50	63.50		19.10	98.60	
1 1/2	1.900	6.120	1.990	0.880	1.250	0.880	2.750	2.880	4	0.880	4.500	2.96
	48.30	155.4	50.50	22.40	31.75	22.40	69.85	73.15		22.40	114.3	
2	2.375	6.900	2.500	1.000	1.440	1.120	3.310	3.620	8	0.750	5.000	3.62
	60.30	165.1	63.50	25.40	36.60	28.40	84.10	91.30		19.10	127.0	
2 1/2	2.875	7.500	3.000	1.120	1.620	1.250	3.940	4.120	8	0.880	5.880	5.28
	73.00	190.5	76.20	28.40	41.10	31.75	100.1	104.6		22.40	149.4	
3	3.500	8.250	3.630	1.250	1.910	1.380	4.620	5.000	8	0.880	6.620	7.00
	88.90	209.6	92.20	31.75	48.00	35.10	117.3	127.0		22.40	168.1	
3 1/2	4.000	9.000	4.130	1.380	1.940	1.560	5.250	5.500	8	1.000	7.250	8.84
	101.6	229.6	104.9	35.10	49.30	39.60	133.4	139.7		25.40	184.2	
4	4.500	10.200	4.630	1.380	2.000	1.440	5.750	6.190	8	1.000	7.880	11.1
	114.3	254.0	117.6	35.10	50.80	36.60	146.1	157.2		25.40	200.2	
5	5.563	11.00	5.690	1.500	2.120	1.690	7.000	7.310	8	1.000	9.250	13.9
	141.3	279.4	144.5	38.10	53.80	42.90	177.8	185.7		25.40	235.0	
6	6.625	12.50	6.750	1.620	2.250	1.810	8.120	8.500	12	1.000	10.62	18.3
	168.3	317.5	171.5	41.10	57.15	46.00	206.2	215.9		25.40	269.7	
8	8.625	15.00	8.750	1.880	2.690	2.000	10.25	10.62	12	1.120	13.00	28.6
	219.1	381.0	222.3	47.80	68.30	50.80	260.4	269.7		28.40	330.2	
10	10.75	17.50	10.88	2.120	2.880	2.190	12.62	12.75	16	1.250	15.25	39.2
	273.0	444.5	276.4	53.80	73.15	55.60	320.5	323.9		31.75	387.4	
12	12.75	20.50	12.94	2.250	3.120	2.380	14.75	15.00	16	1.380	17.75	57.0
	323.8	520.7	328.7	57.15	79.25	60.45	374.7	381.0		35.10	450.9	
14	14.00	23.00	14.19	2.380	3.310	2.500	16.75	16.25	20	1.380	20.25	79.1
	355.6	584.2	360.4	60.45	84.10	63.50	425.5	412.8		35.10	514.4	
16	16.00	25.50	16.19	2.500	3.690	2.690	19.00	18.50	20	1.500	22.50	101
	406.4	647.7	411.2	63.50	93.70	68.30	482.6	469.9		38.10	571.5	
18	18.00	28.00	18.19	2.620	3.880	2.750	21.00	21.00	24	1.500	24.75	123
	457.2	711.2	462.0	66.55	98.60	69.85	533.4	533.4		38.10	628.7	
20	20.00	30.50	20.19	2.750	4.000	2.880	23.12	23.00	24	1.620	27.00	146
	508.0	774.7	512.8	69.85	101.6	73.15	587.2	584.2		41.10	686.6	
24	24.00	36.00	24.19	3.000	4.500	3.250	27.62	27.25	24	1.880	32.00	219
	609.6	914.4	614.4	76.20	114.3	82.60	701.5	692.2		47.80	812.6	

Notes

- The thread conforms to AGME B1.20.1 NTP threads as described in Section 10. (The only exceptions are small male and female plain face threaded flanges which use NPSL locknut threads.)
- Class 300 and higher threaded flanges are counter-bored. Threads are chamfered to the counterbore at an angle of 45° (approx).
- Weights are based on manufacturer's data and are approximate.
- For tolerances see page 8-4.

Threaded Flanges - ANSI B16.5

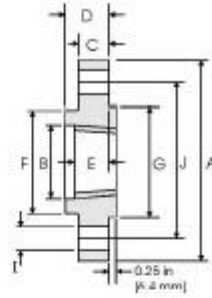

Class 600 lb

Nominal Pipe Size	Pipe	Flange Data					Hub	Flange Face	Drilling Data			Weight	
		A	B	C	D	E	F	G	H	I	J		
	Outside Diameter	Overall Diameter	Counter-bore min.	Flange Thickness min.	Overall Length	Threaded length min.	Hub Diameter	Face Diameter	Number of Holes	Bot Hole Diameter	Diameter of Circle of Holes	kg/ piece	
in	in	in	in	in	in	in	in		in	in			
1/2	0.840	3.750	0.930	0.560	0.620	0.880	0.620	1.500	1.380	4	0.620	2.620	0.74
	21.30	95.20	23.60	14.20	15.70	22.40	15.70	38.10	35.10		15.70	66.65	
3/4	1.050	4.620	1.140	0.620	1.000	0.620	0.880	1.880	1.690	4	0.750	3.250	1.27
	26.70	117.3	29.00	15.70	25.40	15.70	22.40	47.80	42.80		19.10	82.60	
1	1.315	4.880	1.410	0.690	1.060	0.690	1.000	2.120	2.000	4	0.750	3.500	1.52
	33.40	124.0	35.80	17.50	26.90	17.50	25.40	53.80	50.80		19.10	89.50	
1 1/4	1.650	5.250	1.750	0.810	1.120	0.810	1.250	2.500	2.500	4	0.750	3.850	2.03
	42.20	133.4	44.50	20.60	28.40	20.60	31.75	63.50	63.50		19.10	98.50	
1 1/2	1.900	6.120	1.990	0.880	1.250	0.880	1.500	2.880	2.880	4	0.880	4.500	2.96
	48.30	155.4	50.50	22.40	31.75	22.40	38.10	73.15	73.15		22.40	114.3	
2	2.375	6.500	2.500	1.000	1.440	1.120	3.310	3.620	3.620	8	0.750	5.000	3.62
	60.30	165.1	63.50	25.40	36.60	28.40	84.10	91.90	91.90		19.10	127.0	
2 1/2	2.875	7.500	3.000	1.120	1.620	1.250	3.940	4.120	4.120	8	0.880	5.880	5.28
	73.00	190.5	76.20	28.40	41.10	31.75	100.1	104.6	104.6		22.40	149.4	
3	3.500	8.250	3.630	1.250	1.810	1.380	4.620	5.000	5.000	8	0.880	6.620	7.00
	88.90	209.5	92.20	31.75	45.00	35.10	117.3	127.0	127.0		22.40	168.1	
3 1/2	4.000	9.000	4.130	1.380	1.940	1.560	5.250	5.500	5.500	8	1.000	7.250	8.84
	101.6	228.6	104.9	35.10	49.30	39.60	133.4	139.7	139.7		25.40	184.2	
4	4.500	10.75	4.630	1.500	2.120	1.620	6.000	6.190	6.190	8	1.000	8.500	14.5
	114.3	273.1	117.6	38.10	53.80	41.10	152.4	157.2	157.2		25.40	215.9	
5	5.563	13.00	5.690	1.750	2.380	1.880	7.440	7.310	7.310	8	1.120	10.50	24.4
	141.3	330.2	144.5	44.50	60.45	47.80	189.0	185.7	185.7		28.40	266.7	
6	6.625	14.00	6.750	1.880	2.620	2.000	8.750	8.500	8.500	12	1.120	11.50	28.7
	168.3	355.6	171.5	47.80	66.55	50.80	222.3	215.9	215.9		28.40	292.1	
8	8.625	16.50	8.750	2.190	3.000	2.250	10.75	10.62	10.62	12	1.250	13.75	43.4
	219.1	419.1	222.3	55.60	76.20	57.15	273.1	269.7	269.7		31.75	349.3	
10	10.75	20.00	10.88	2.500	3.380	2.560	13.50	12.75	12.75	16	1.380	17.00	70.3
	273.0	508.0	276.4	63.50	85.90	65.00	342.9	323.9	323.9		35.10	431.8	
12	12.75	22.00	12.94	2.820	3.620	2.750	15.75	15.00	15.00	20	1.380	19.25	84.2
	323.8	558.8	328.7	66.55	91.90	69.95	400.1	381.0	381.0		35.10	489.0	
14	14.00	23.75	14.19	2.750	3.690	2.880	17.00	16.25	16.25	20	1.500	20.75	98.7
	355.6	603.3	360.4	69.85	93.70	73.15	431.8	412.8	412.8		38.10	527.1	
16	16.00	27.00	16.19	3.000	4.190	3.060	19.50	18.50	18.50	20	1.620	23.75	142
	406.4	685.8	411.2	76.20	106.4	77.70	495.3	469.9	469.9		41.10	603.3	
18	18.00	29.25	18.19	3.250	4.620	3.120	21.50	21.00	21.00	20	1.750	25.75	173
	457.2	743.0	462.0	82.60	117.3	79.25	546.1	533.4	533.4		44.50	654.1	
20	20.00	32.00	20.19	3.500	5.000	3.250	24.00	23.00	23.00	24	1.750	28.50	220
	508.0	812.8	512.8	88.90	127.0	82.60	609.6	584.2	584.2		44.50	723.9	
24	24.00	37.00	24.19	4.000	5.500	3.620	28.25	27.25	27.25	24	2.000	33.00	312
	609.6	939.8	614.4	101.6	139.7	91.90	717.6	692.2	692.2		50.80	838.2	

Notes

- The thread conforms to ASME B1.20.1 NTP threads as described in Section 10. (The only exceptions are small male and female plain face threaded flanges which use NPSL locknut threads.)
- Class 300 and higher threaded flanges are counter-bored. Threads are chamfered to the counterbore at an angle of 45° (approx).
- Weights are based on manufacturer's data and are approximate.
- For tolerances see page 8-4.

Threaded Flanges - ANSI B16.5

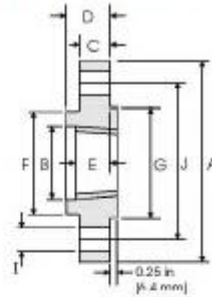

Class 900 lb

Nominal Pipe Size	Pipe		Flange Data					Hub	Raised Face	Drilling Data			Weight
	Outside Diameter	Diameter Overall	Counter-bore	Flange Thickness	Overall Length	Threaded length	Hub Diameter	Face Diameter	Number of Holes	Bolt Hole Diameter	Diameter of Circle of Holes	kg/ piece	
													A
1/2	0.840 21.30	4.750 120.6	0.930 23.60	0.880 22.30	1.250 31.70	0.880 22.30	1.500 38.10	1.380 35.10	4	0.880 22.30	3.250 82.50	1.74	
3/4	1.050 26.70	5.120 130.0	1.140 29.00	1.000 25.40	1.380 35.00	1.000 25.40	1.750 44.40	1.690 42.90	4	0.880 22.30	3.500 88.90	2.34	
1	1.315 33.40	5.880 149.3	1.410 35.80	1.120 28.40	1.620 41.10	1.120 28.40	2.060 52.30	2.000 50.80	4	1.000 25.40	4.000 101.6	3.44	
1 1/4	1.660 42.20	6.250 159.7	1.750 44.40	1.120 28.40	1.620 41.10	1.190 30.20	2.500 63.50	2.500 63.50	4	1.000 25.40	4.380 111.2	3.91	
1 1/2	1.900 48.20	7.000 177.8	1.990 50.50	1.250 31.70	1.750 44.50	1.250 31.70	2.750 69.85	2.880 73.15	4	1.120 28.40	4.880 123.9	5.36	
2	2.375 60.30	8.500 215.9	2.500 63.50	1.500 38.10	2.250 57.15	1.500 38.10	4.120 104.6	3.620 91.90	8	1.000 25.40	6.500 165.1	9.85	
2 1/2	2.875 73.00	9.620 244.3	3.000 76.20	1.620 41.10	2.500 63.50	1.880 47.70	4.880 123.9	4.120 104.6	8	1.120 28.40	7.500 190.5	13.7	
3	3.500 88.90	9.500 241.3	3.630 92.20	1.500 38.10	2.120 53.80	1.620 41.10	5.000 127.0	5.000 127.0	8	1.000 25.40	7.500 190.5	11.6	
4	4.500 114.3	11.50 292.1	4.630 117.6	1.750 44.40	2.750 69.85	1.880 47.80	6.250 158.7	6.190 157.2	8	1.250 31.70	9.250 234.9	19.7	
5	5.563 141.3	13.75 349.2	5.690 144.5	2.000 50.80	3.120 79.25	2.120 53.80	7.500 190.5	7.310 185.7	8	1.380 35.00	11.00 279.4	31.9	
6	6.625 168.3	15.00 381.0	6.750 171.4	2.190 55.60	3.380 85.80	2.250 57.15	9.250 234.9	8.500 215.9	12	1.250 31.70	12.50 317.5	41.1	
8	8.625 219.1	18.50 469.9	8.750 222.2	2.500 63.50	4.000 101.6	2.500 63.50	11.75 298.4	10.62 269.7	12	1.500 38.10	15.50 393.7	70.7	
10	10.75 273.0	21.50 546.1	10.88 276.3	2.750 69.85	4.250 107.9	2.810 71.40	14.50 368.3	12.75 323.9	16	1.500 38.10	18.50 469.9	101	
12	12.75 323.8	24.00 609.6	12.94 328.7	3.120 79.40	4.620 117.3	3.000 76.20	16.50 419.1	15.00 381.0	20	1.500 38.10	21.00 533.4	133	
14	14.00 355.6	25.25 641.3	14.19 360.4	3.380 85.70	5.120 130.0	3.250 82.50	17.75 450.8	16.25 412.7	20	1.620 41.10	22.00 558.8	153	
16	16.00 406.4	27.75 704.8	16.19 411.2	3.500 88.90	5.250 133.3	3.380 85.80	20.00 508.0	18.50 469.9	20	1.750 44.40	24.25 619.9	185	
18	18.00 457.2	31.00 787.4	18.19 462.0	4.000 101.6	6.000 152.4	3.500 88.90	22.25 565.1	21.00 533.4	20	2.000 50.80	27.00 685.8	258	
20	20.00 508.0	33.75 857.2	20.19 512.8	4.250 107.9	6.250 158.7	3.630 91.90	24.50 622.3	23.00 584.2	20	2.120 53.80	29.50 749.3	317	
24	24.00 609.6	41.00 1041.4	24.19 614.4	5.000 127.0	8.000 203.2	4.000 101.6	29.50 749.3	27.25 692.7	20	2.620 66.55	35.50 901.7	606	

Notes

- The thread conforms to AGME B1.20.1 NTP threads as described in Section 10. (The only exceptions are small male and female plain face threaded flanges which use NPSL locknut threads.)
- Class 300 and higher threaded flanges are counter-bored. Threads are chamfered to the counter-bore at an angle of 45° (approx).
- Weights are based on manufacturer's data and are approximate.
- For tolerances see page 8-4.

Threaded Flanges - ANSI B16.5

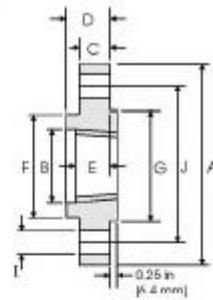

Class 1500 lb

Nominal Pipe Size	Pipe		Flange Data					Hub	Raised Face	Drilling Data			Weight
	A	B	C	D	E	F	G	H	I	J	kg/ piece		
	Outside Diameter	Overall Diameter	Counter-bore Dia	Flange Thickness	Overall Length	Threaded length	Hub Diameter	Face Diameter	Number of Holes	Bolt Hole Diameter		Diameter of Circle of Holes	
in mm	in mm	in mm	in mm	in mm	in mm	in mm	in mm	in mm	in mm	in mm	in mm		
1/2	0.840 21.30	4.750 120.6	0.930 23.60	0.880 22.30	1.250 31.70	0.880 22.30	1.500 38.10	1.380 35.00	4	0.880 22.30	3.250 82.50	1.74	
	1.050 26.70	5.120 130.0	1.140 29.00	1.000 25.40	1.380 35.00	1.000 25.40	1.750 44.40	1.690 42.90	4	0.880 22.30	3.500 88.90	2.34	
3/4	1.315 33.40	5.880 149.3	1.410 35.80	1.120 28.40	1.620 41.10	1.120 28.40	2.060 52.30	2.000 50.80	4	1.000 25.40	4.000 101.6	3.44	
	1.660 42.20	6.250 158.7	1.750 44.40	1.120 28.40	1.620 41.10	1.190 30.20	2.500 63.50	2.500 63.50	4	1.000 25.40	4.380 111.2	3.91	
1 1/4	1.900 48.30	7.000 177.8	1.990 50.50	1.250 31.70	1.750 44.50	1.250 31.70	2.750 69.85	2.880 73.15	4	1.120 28.40	4.880 123.9	5.36	
	2.375 60.30	8.500 215.9	2.500 63.50	1.500 38.10	2.350 57.15	1.500 38.10	4.120 104.6	3.620 91.90	8	1.000 25.40	6.500 165.1	9.85	
2	2.875 73.00	9.620 244.3	3.000 76.20	1.620 41.10	2.500 63.50	1.880 47.70	4.880 123.9	4.120 104.6	8	1.120 28.40	7.500 190.5	13.7	

Notes

- The thread conforms to ASME B1.20.1 NTP threads as described in Section 10. (The only exceptions are small male and female plain face threaded flanges which use NPSL locknut threads.)
- Class 300 and higher threaded flanges are counter-bored. Threads are chamfered to the counterbore at an angle of 45° (approx).
- Weights are based on manufacturers data and are approximate.
- For tolerances see page 8-4.

Threaded Flanges - ANSI B16.5

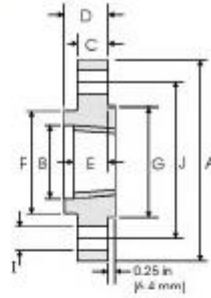

Class 2500 lb

Nominal Pipe Size	Pipe	Flange Data					Hub	Raised Face	Drilling Data			Weight
		A	B	C	D	E	F	G	H	I	J	
	Outside Diameter	Overall Diameter	Counter-bore dia.	Flange Thickness	Overall Length	Threaded length	Hub Diameter	Face Diameter	Number of Holes	Bolt Hole Diameter	Diameter of Circle of Holes	kg/ piece
in mm	in mm	in mm	in mm	in mm	in mm	in mm	in mm	in mm		in mm	in mm	
1/2	0.840	5.250	0.930	1.190	1.560	1.120	1.690	1.380	4	0.880	3.500	2.95
	21.30	133.4	23.60	30.20	39.60	28.40	42.90	35.10		22.40	88.90	
3/4	1.050	5.500	1.140	1.250	1.690	1.250	2.000	1.690	4	0.880	3.750	3.44
	26.70	139.7	29.00	31.75	42.90	31.75	50.80	42.90		22.40	95.30	
1	1.315	6.250	1.410	1.360	1.880	1.380	2.250	2.000	4	1.000	4.250	4.82
	33.40	158.8	35.80	35.10	47.80	35.10	57.15	50.80		25.40	108.0	
1 1/4	1.650	7.250	1.750	1.500	2.060	1.500	2.380	2.500	4	1.120	5.120	7.14
	42.20	184.2	44.50	38.10	52.30	38.10	73.15	63.50		28.40	130.0	
1 1/2	1.900	8.000	1.990	1.750	2.380	1.750	3.120	2.880	4	1.250	5.750	10.0
	48.30	203.2	50.50	44.50	60.45	44.50	79.25	73.15		31.75	146.1	
2	2.375	9.250	2.500	2.000	2.750	2.000	3.750	3.620	8	1.120	6.750	14.8
	60.30	235.0	63.50	50.80	69.85	50.80	95.30	91.80		28.40	171.5	
2 1/2	2.875	10.50	3.000	2.250	3.120	2.250	4.500	4.120	8	1.250	7.750	21.5
	73.00	266.7	76.20	57.15	79.25	57.15	114.3	104.6		31.75	196.9	

Notes

- The thread conforms to ASME B1.20.1 NTP threads as described in Section 10. (The only exceptions are small male and female plain face threaded flanges which use NPSL locknut threads.)
- Class 300 and higher threaded flanges are counter-bored. Threads are chamfered to the counterbore at an angle of 45° (approx).
- Weights are based on manufacturer's data and are approximate.
- For tolerances see page 8-4.

Tianjin All Best International Trade Co., Ltd is a famous provider of steel pipe fittings.

Our business involves Oil & Gas Industry, Mining Industry, Automobile Industry, Chemical Industry and Construction Industry.

Our products include elbow, flange, reducer, pipe cap, tee and corrugated expansion joint and seamless steel line pipe. We have got good recognition from our customers in South America, South East Asia and North Africa.

These pipe fittings can be made according to both GB and International standards, ASME, DIN, BS, JIS & GOST. In the last years, we got API 5L, and API Q1 international certification for the products. ISO9001, ISO14001, and OHAS18001 are three basic certificates for our quality, service, environment and workers' qualification.

Our factory covers an area of 70000 square meters in Xiwang New District, Mengcun County, Cangzhou, Hebei, China. With advanced equipment, excellent management, skilled workers, and ambitious salesmen, we have great confidence to provide you with better products with the most reasonable price. To win customers's belief in us is the goal for the whole company for ever.

Welcome you to visit us in China or send emails to us. We love friends and like the reply buttons.

Contact us:

Litas Lee,

Telephone: 02287802560

Mobile:8615522509091

Fax:02287808131

E-mail:sale01@tianjin-all-best.com

Skype: Litas.Lee

QQ:482171537

Tianjin All Best International Ltd

Sunny Plaza,Huanghe Road,Nankai District,Tianjin, China

Factory: Xiwang New District, Mengcun, Cangzhou, hebei, China

<http://www.tianjin-all-best.com/>