

# DS-58SW31ZY DC WORM GEAR MOTOR

Main Voltage : 6VDC、12VDC、24VDC

Typical Applications :

Optical instrument, Surveillance cameras, Automated energy efficiency, Water saving equipment, IC water card, Toys and gifts, Office equipment, Household appliance, automation equipment



## APPEARANCE SIZE

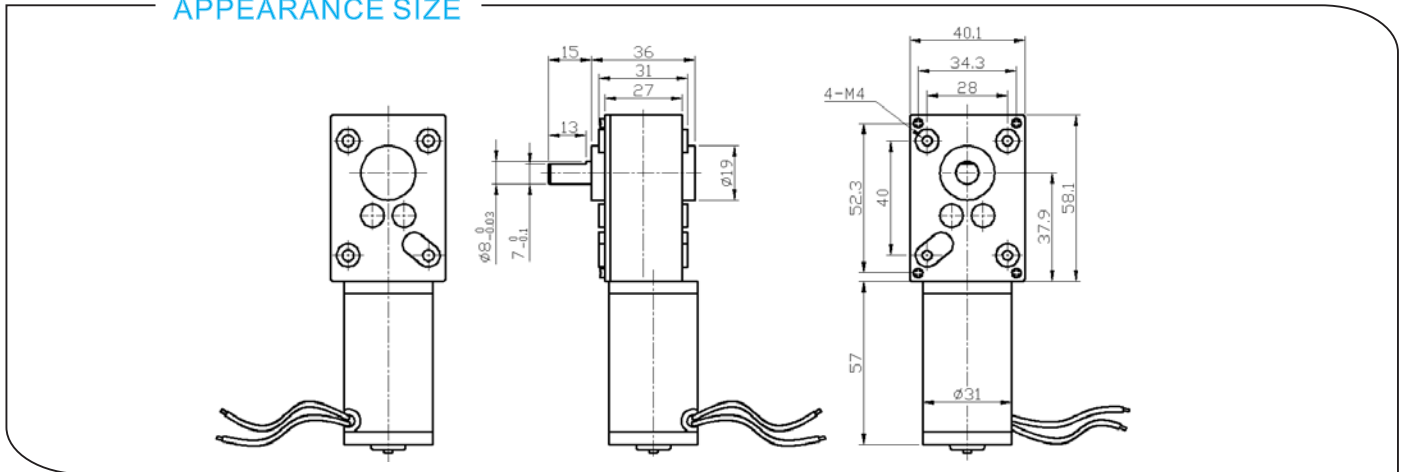

## Gearbox Data:

Number of stages	3	4
Reduction ratio	49、74、101、218、290	505、634
Gearbox length "L"mm	34	34
Breaking torque(kgf.cm)	15	35
Gearbox efficiency	40%	36%

## Driving Motor Data:

Motor model	Rated Volt.	No load		Load				Stall	
		Current	Speed	Current	Speed	Torque	Output power	Torque	Current
		V	mA	r/min	mA	r/min	gf.cm	W	gf.cm
DS-31ZY-012-3000	12	≤100	3000	≤400	2200	90	2.0	360	1600
DS-31ZY-012-4500	12	≤150	4500	≤700	3300	130	4.4	520	2700
DS-31ZY-012-6000	12	≤220	6000	≤1200	4500	180	8.3	720	5000
DS-31ZY-024-3000	24	≤60	3000	≤200	2200	90	2.0	360	800
DS-31ZY-024-4500	24	≤90	4500	≤350	3300	130	4.4	520	1300
DS-31ZY-024-6000	24	≤130	6000	≤650	4500	180	8.3	720	2600

## Remark:

Gear Motor Torque=Driving motor torque\*Reduction ratio\*Gearbox efficiency;

Gear Motor Speed=Driving motor speed/Reduction ratio

Motor detailed config can be customized according to customer's requests, like voltage,speed,as well as shaft length and shape...

Welcome OEM or ODM projects