

A

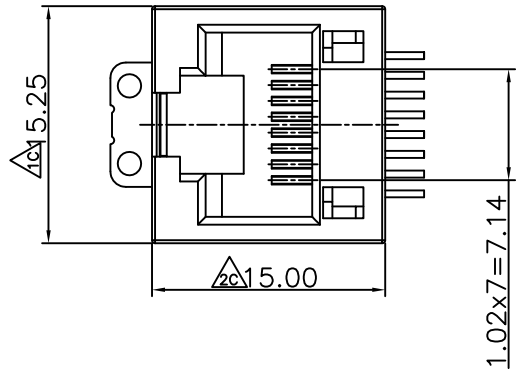

B

C

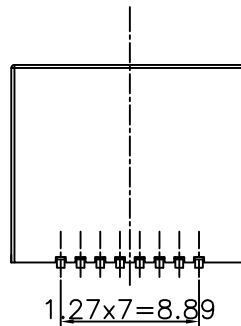
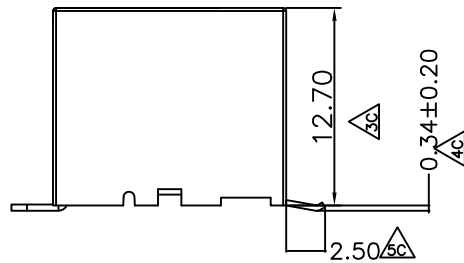

**Electrical:**  
 1.Voltage Rating:125 Vac Rms.  
 2.Current Rating:1.5 Amp.  
 3.Contact Resistance:40 Milliohms Max.  
 4.Insulation Resistance:1000 Megohms Min @500 Vdc.  
 5.Dielectric Strength:1000 Vac Rms 60Hz, 1Min.  
**Mechanical:**  
 1.Operating:750 Cycles Min.  
**Environmental:**  
 1.Storage:-40°C To +85°C.  
 2.Operation:-20°C To +75°C.  
 3.IR Reflow Soldering Temperature:255°C To 265°C(5~10 Seconds).  
 Mates With Modular Plug Conforming To FCC Part 68, Subpart F.

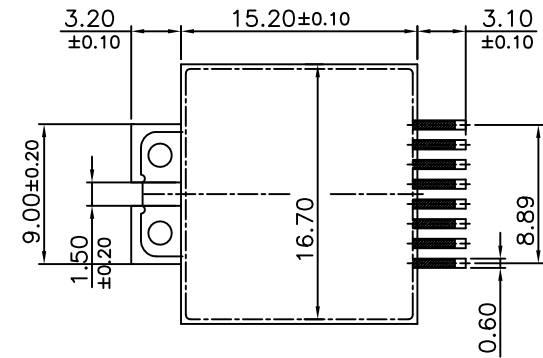

PCB LAYOUT/TOP VIEW

**MATERIALS:**  
 PLASTIC HOUSING: HIGH TEMP THERMOPLASTIC  
 FLAMMABILITY RATING UL 94V-0.  
 CONTACTS: PHOSPHOR BRONZE  
 PLATING: GOLD PLATING OVER NICKEL IN CONTACT.  
 TIN PLATING OVER NICKEL IN SOLDER AREA.  
 SOLDER PAD: BRASS WITH TIN PLATING OVER NICKEL.

黑殼紅基座: 6u" P/N J268359971  
 15u" P/N J268359972  
 30u" P/N J268359973  
 50u" P/N J268359974

<b>J-CON</b>			
UNIT	SCALE	SHEET	TITLE :
mm	1/1	1 of 1	TOP ENTRY PCB SMT JACK (無斷差8P8C)
DRAWN BY	APPROVED BY		DRAW NO :
Alan 110425	Alan 110425		J268359971
General tolerance			REV.
.XX ±0.10			A
.XX ±0.25			
.X ±0.38			
X ±0.50			
ANG ±.3			