



S Type Load Cell

Model: MS - 1



Material: Alloy Steel Stainless Steel

S Type Load cell, tension and compression

Good output symmetry, compact structure, simple to install, full range of capacities

Suitable for electromechanical scale, crane scale, hopper scale and various special scales

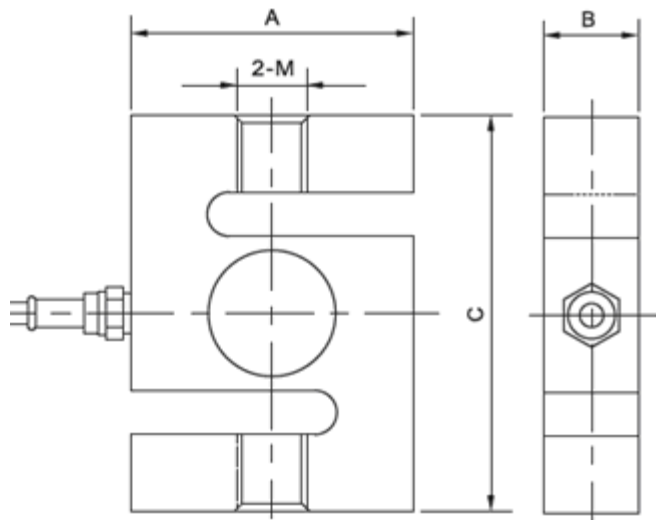

Specification	
Rated Output	2.00±0.010, 3.00±0.010
Nonlinearity	±0.02%FS
Hysteresis	±0.02%FS
Repeatability	±0.01%FS
Creep(30 minutes)	±0.02%FS
Zero balance	±1.00%FS
Temperature effect on zero	±0.02%FS/10°C
Temperature effect on output	±0.02%FS/10°C
Input resistance (Ω)	385±10
Output resistance (Ω)	350±3
Insulation resistance	≥5000MΩ
Excitation voltage	10V(DC/AC)
Compensated temperature range	-10~+50°C
Operating temperature range	-20~+60°C
Safe overload	120%FS
Cable	Φ5.4*5m
Cable color code	Input: red+ black- Output: green+ white-

Capacity		Size mm			Thread	
Klb	Kg	A	B	C	Metric	Inch
0.025-0.15	5-50	51.0	13.0	64.0	M8*1.25	1/4-28
0.2-1.5	100-500	51.0	19.1	76.0	M12*1.75	1/2-20
2-4	1t-2t	54.0	25.4	76.0	M12*1.75	1/2-20
5-10	2.5t-5t	76.0	25.4	108.0	M18*1.5	3/4-16
15	7.5t	100.0	32.0	140.0	M24*2	1-14
20	10t	126.0	50.0	178.0	M30*2	1 1/4 -12
30-40	15t-20t	140.0	60.0	188.0	M39*2	1 1/2 -12