

Product series: US

MODEL 47 - xx VSC(A) (P)(R)(X)(T)

型号 47 - xx VSC(A) (P)(R)(X)(T)



General Characteristics

Function:

- Single pole switch with halfwave or full wave speed control electronics and bypass contact.
- Also available as On/Off switch.

Optional:

- Lock button, various shapes and dimensions available.
- Reversing module with zero current switching rotation mode.
- Jumper wires between reversing module and main switch.
- Potentiometer.
- External power component and heatsink for higher loads.
- Adjustable knob, various shapes and dimensions available.
- Various shapes and dimensions of trigger head and reversing lever.

Terminals:

- Push-in terminals.

Applications:

- Class II appliances, such as Drill, Jigsaw, Sander, Polisher, Circular Saw, Reciprocating saw.

一般的规格参数

产品功能:

- 具有可变速度和全速控制的单极开关。
- 半波输出或者全波输出。
- On-Off 版本。

可选择的附加功能:

- 工作锁定按钮, 其形状和尺寸可按客户要求定制。
- 带工具断电时换向模块。
- 连接换向模块和开关主体的导线。
- 可变电阻输出。
- 外置可控硅可以使开关能够承受大电流。
- 调速限位旋钮, 其形状和尺寸可按客户要求定制。
- 扳机和换向杆的形状和尺寸可按客户要求定制。

端子:

- 插线端子连接。

应用:

- 使用在 II 类器具上, 例如电钻, 曲线锯, 抛光机, 磨光机, 圆锯, 往复锯。

Circuit Diagram 原理图

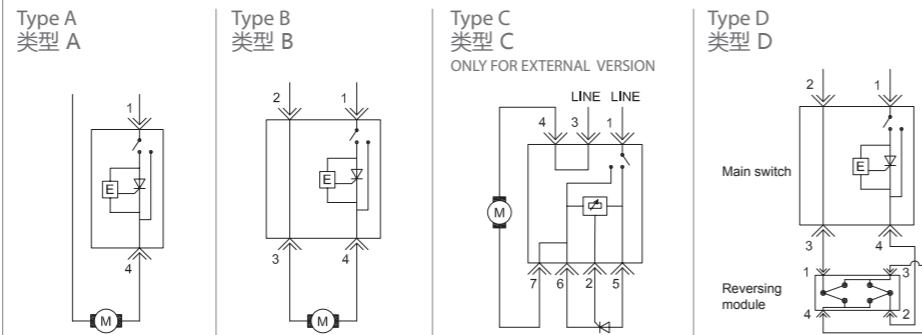

Approvals 安规认证

Models	Approbation:		
Mod : 47	6(6)A up to 8(8)A 125Vac 5E4 (Internal version) 8(8)A up to 13(13)A 125Vac 5E4 (External version)	4(4)A up to 6(6)A 250Vac 5E4	4(4)A up to 6(6)A 250Vac 5E4

Switch Base Shape (开关)本体形状

I Internal version 内置版本

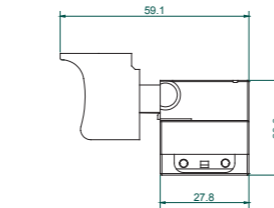
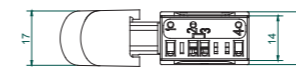

II External version 外置版本

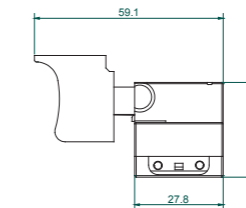
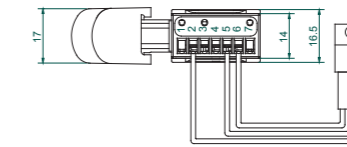

III Internal version with Lock On button 内置带锁的版本

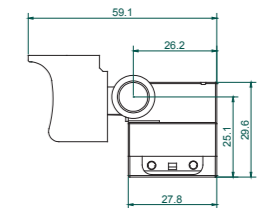
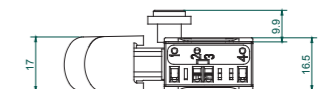

IV Adjustable speed version 可选带限速旋钮版本

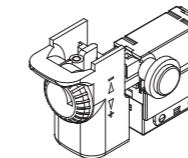
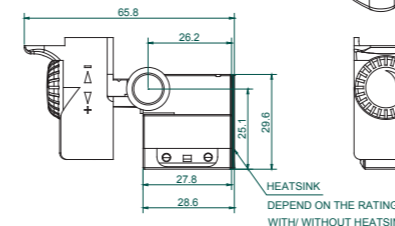
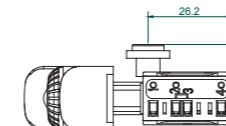

V With Reversing module 带可选的换向功能版本

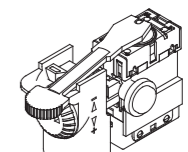
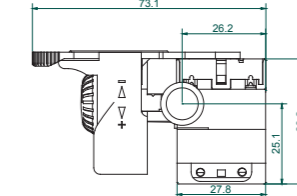
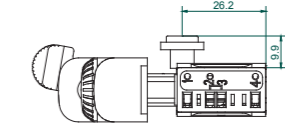

Triggerhead Options 可选的扳机形状

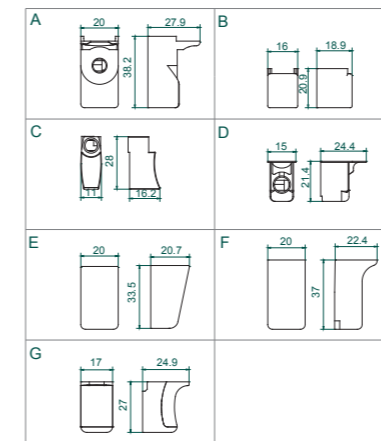

Lockbutton Options 可选的锁的形状

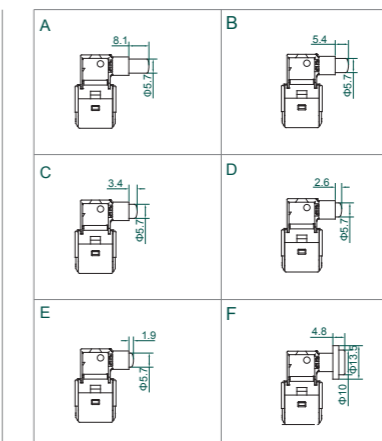

Lever Options 可选的换向杆形状

