



Shear Beam Load Cell Model: CG-1



Materials: Alloy Steel, Stainless Steel

Hermetically sealed, double diaphragm structure, nice and handy shape, good stability and repeatability, small angle error around 360° direction, fast dynamic response.

Suitable for kinds of measuring equipments and weighing scales

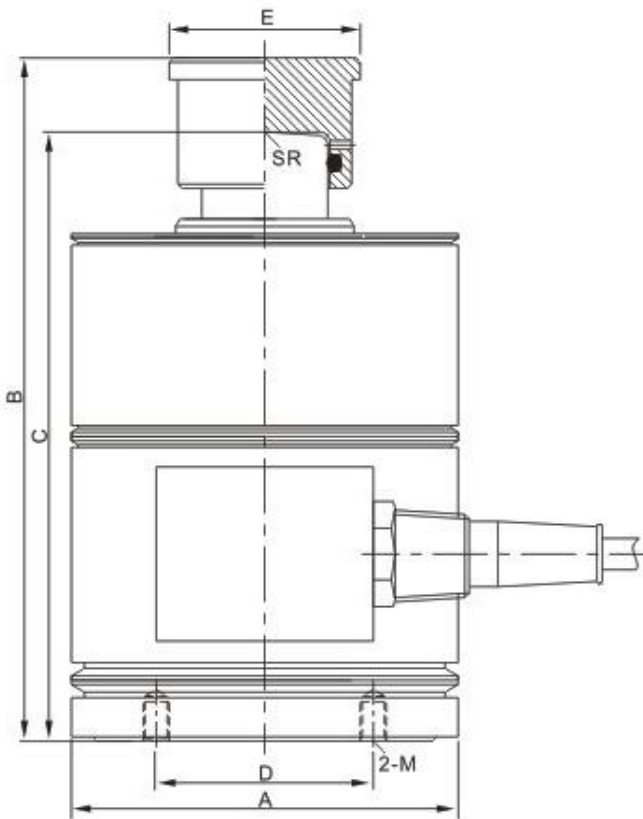

Specification	
Rated Output	2.00±0.010
Nonlinearity	±0.03%FS
Hysteresis	±0.03%FS
Repeatability	±0.02%FS
Creep(30 minutes)	±0.03%FS
Zero balance	±1.00%FS
Temperature effect on zero	±0.03%FS/10°C
Temperature effect on output	±0.03%FS/10°C
Input resistance (Ω)	385±10
Output resistance (Ω)	350±5
Insulation resistance	≥5000MΩ
Excitation voltage	10V(DC/AC)
Compensated temperature range	-10~+50°C
Operating temperature range	-20~+60°C
Safe overload	120%FS
Cable	Φ5.4X6 M
Cable color code	Input: red+ black- Output: green+ white-

Capacity	Size mm						
	t	A	B	C	D	E	SR
1-10	89.0	157.0	140.0	50.0	44.0	120.0	M6
20-50	145.0	280.0	230.0	90.0	90.0	250.0	M10
100	204.0	330.0	300.0	130.0	96.0	350.0	M16
200	242.0	420.0	350.0	160.0	116.0	600.0	M20