



Single Point Load Cell Model: PE-2A



Specification

Rated Output	$2 \pm 0.10 \text{ MV/V}$
Nonlinearity	$\pm 0.02\% \text{ FS}$
Hysteresis	$\pm 0.02\% \text{ FS}$
Repeatability	$\pm 0.01\% \text{ FS}$
Creep(30 minutes)	$\pm 0.02\% \text{ FS}$
Zero balance	$\pm 1.00\% \text{ FS}$
Temperature effect on zero	$\pm 0.02\% \text{ FS}/10^\circ\text{C}$
Temperature effect on output	$\pm 0.02\% \text{ FS}/10^\circ\text{C}$
Input resistance (Ω)	$410 \pm 15 \Omega$
Output resistance (Ω)	$350 \pm 3 \Omega$
Insulation resistance	$\geq 5000 \text{ M}\Omega$
Excitation voltage	10 V (DC/AC)
Compensated temperature range	$-10 \sim +50^\circ\text{C}$
Operating temperature range	$-20 \sim +60^\circ\text{C}$
Safe overload	120%FS
Cable	$\Phi 5. 4 \times 3 \text{ M}$
Cable color code	Input: red+ black- Output: green+ white-

Material: Aluminum, Stainless Steel
 Double parallel cantilever beam load cell.
 Temperature compensated and four corners adjusted. Low profile, small size..
 Suitable for electronic price computing scale, table top scale, platform scale and other small capacity electronic scale.

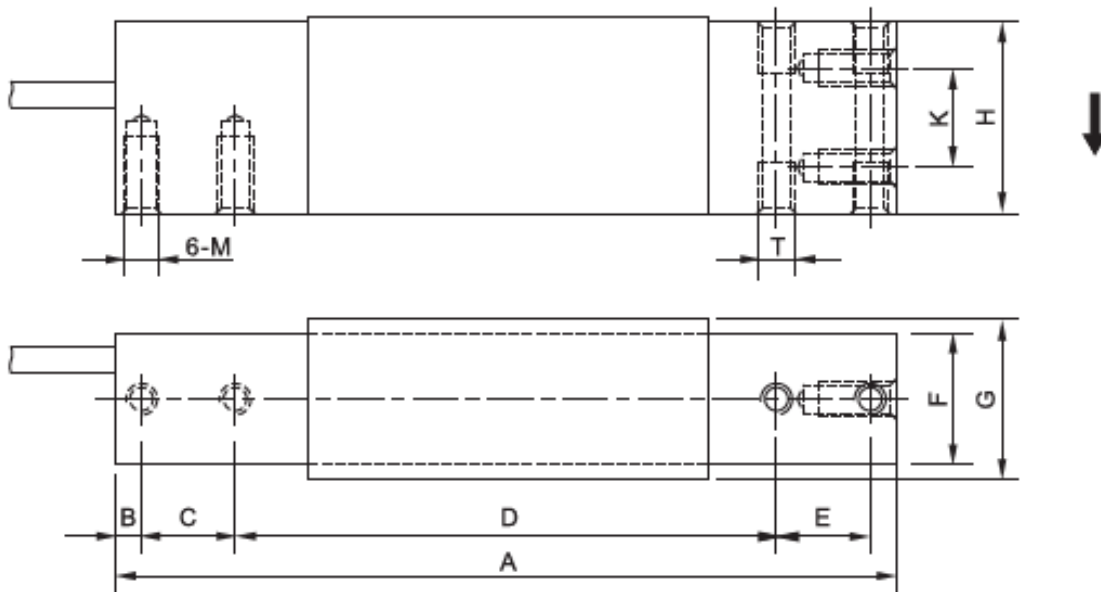

Capacity	Size										
	A	B	C	D	E	F	G	H	K	M	T
Kg	150.0	6.0	19.0	100.0	19.0	25.4	30.0	40.0	19.0	1/4-20	1/4-28