

POWER RELAY



To learn more new products and services ,email us or visit our website today.

<http://www.vicon-relay.com>

Type: VP30



43.0 × 35.5 × 48.0mm

① Ordering Information

VP30 - 12 VDC - 2C

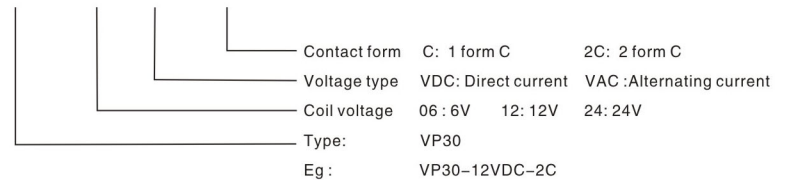

② Coil Ratings

Coil voltage(V)	AC: 6 12 24 48 120 220/240
	DC: 6 9 12 24 48 110 220
Coil power	4.0VA / DC 2.5W

③ Contact Data

Contact Form	1A 1B 1C 2A 2B 2C
Contact Material	Silver alloy
Max. Allowable Contact Current(A)	30A
Max.Switching Voltage	250VAC/28VDC
Max.Switching Power	7500VA/840w
Rated load	30A 250VAC/28VDC

④ Specifications

Insulation Resistance	1000mΩ
Dielectric Strength (Between coil and contacts)	2500VAC
Ambient Temperature	-40°C to 70°C
Operate/release time max.	20ms / 15ms
Mechanical Endurance min	1 × 10 ⁷ ops
Electrical Endurance min	5 × 10 ⁴ ops

⑤ Outline Dimensions ,Wiring Diagram and PCB layout.

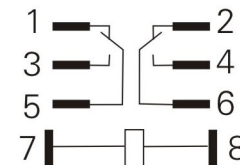
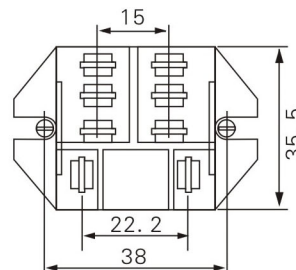
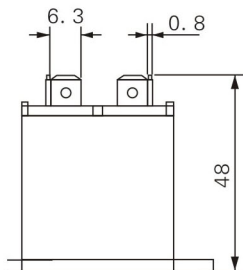

Tolerance : ± 0.2 mm

⑥ Packing information: 200pcs /ctn G.W :18 kgs Carton dimensions (CM): 52 × 27 × 34