

■ LS-65

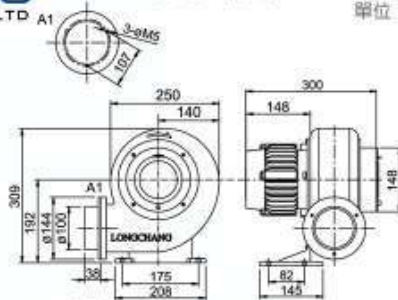

■ LS-65B

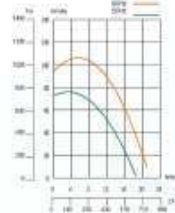
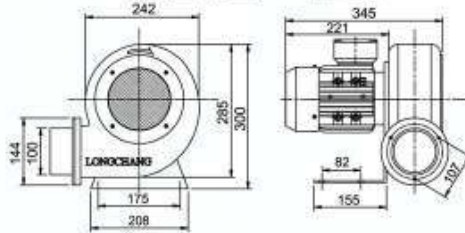

■ LS-650

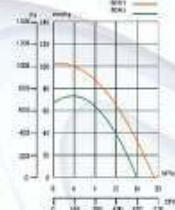
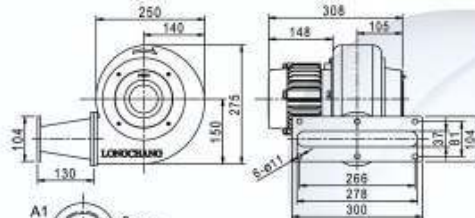

■ LSH-65

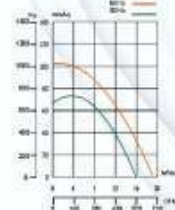
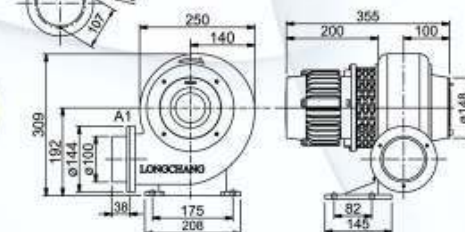

型號 Model	口徑 Outlet Dimension	馬力 Power HP	功率 Rating Kw	電壓 Rated Voltage V	頻率 Frequency Hz	相數 Phase ø	電流 Current A	轉速 Speed r. p. m	風量 Air Flow M³/min	靜壓 Pressure mmHg	重量 Weight KG
	mm										
LS-65	100	1/2	0.37	380	50	1,3	1	2800	20	75	17.3
				220	60		2	3500	24	105	
				110/220	60		2.5	3500	24	105	
LS-65B	100	1/2	0.37	380	50	1,3	1	2800	20	75	11.8
				220	60		2	3500	24	105	
				110/220	60		2.5	3500	24	105	
LS-650	104x300	1/2	0.37	380	50	1,3	1	2800	20	75	17.3
				220	60		2	3500	24	105	
				380	50		1	2800	20	75	
LSH-65	100	1/2	0.37	380	50	1,3	1	2800	20	75	18
				220	60		2	3500	24	105	

備註：
 Remark :
 LS-65 : 1. 1/2HP~1HP 2.另有單項電源，型號：LS-60。 3.風葉有送風以及送料兩種可供選擇。 4.多翼式葉片可選擇不鏽鋼材質。
 LSH-65 : 熱風循環，吸排兩用，耐熱可達180°
 Hot air circulation, for both suction and exhaust ventilation, heat-resistance to 180°