

## PS

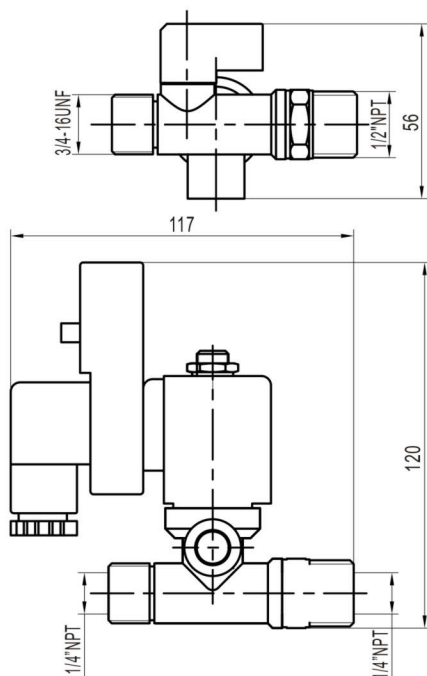

### ★ Speciality

- ★ The drain valve uses for the pipe system of air compressor that to drain off Water automatically and manually.
- ★ It adopts parallel connection design of timed automatic outlet and manual drain port.
- ★ It drains off water and sewage fastly. Good appearance and convenient for usage.

### ★ Parameters

Model		PS
Working pressure		0~16BAR
Ambient Temperature		-20~60℃
Working medium		Water
Highest Medium Temperature		90℃
Voltage		24~240V DC/AC 50/60Hz±10%
Orifice		4mm
Valve body		Brass
Insulation and Protection Class		H Class,IP65
Connection thread	Female	1/4"~1/2" NPT, BSP
	Male	