

WEIGHING*SENSING*MEASUREMENT

CZL803



Applications:

- Floor scales, Tank weighing, Bin and Hopper weighing, etc.
 - Interchangeable with Revere 5123, 9123, Sensortronics 65023
- Stainless Steel available: TW65023SS

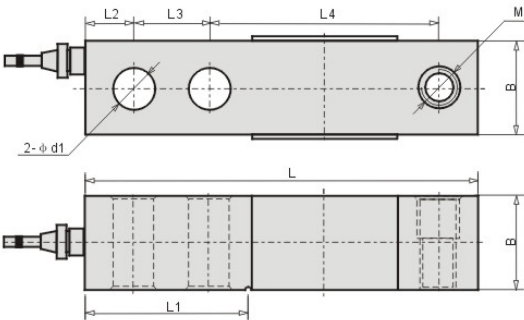

Capacity	L	L1	L2	L3	L4	d	B	M
1.5~4(klb) 0.5~2(t)	130	56.5	15.8	25.4	76.2	13.5	31.8	M12x1.75
5~15(klb) 2.5~5(t)	171.5	77.2	19.1	38.1	95.3	20	38.1	M18x1.5
20(klb) 10(t)	222.3	101.6	25.4	50.8	120.7	26.2	50.8	M24x2



PRODUCT PARAMETER

CAPACITY: 500kg, 1t, 2t, 2.5t, 3t, 5t, 10t

Rated output 3.0mV/V±10%

Accuracy Class C3, 0.02%

Non-linearity 0.02%F.S

Hysteretic 0.02%F.S

Non-repeatability 0.02%F.S

Creep in 30 minutes 0.02%F.S

Temperature effect span 0.02%F.S/10°C

Temperature effect zero 0.03%F.S/10°C

Compensated temperature range -10°C~40°C

Operating temperature range -40°C~65°C

Cable wires

•Red] +input [•Green] +output [•Black] -input [•White] -output

Zero balance ±1% F.S

Input resistance 350±5Ω

Output resistance 350±3Ω

Safe overload 150% F.S

Ultimate overload 300% F.S

Excitation voltage 9VDC-12DC

Recommend platform size 400mm*600mm

Insulation resistance ≥5000MΩ(50V DC)

Environmental protection IP66

Material Alloy Steel, Stainless Steel

ALL THE SPECIFICATIONS ARE SUBJECT TO CHANGE WITHOUT PRIOR NOTICE
SENTECHS CO., LIMITED WWW.SENSORTECS.COM
TEL: +86-574-66267500 FAX: +86-574-62805266