

气动薄型球阀 Pneumatic Thin Type Ball Valve

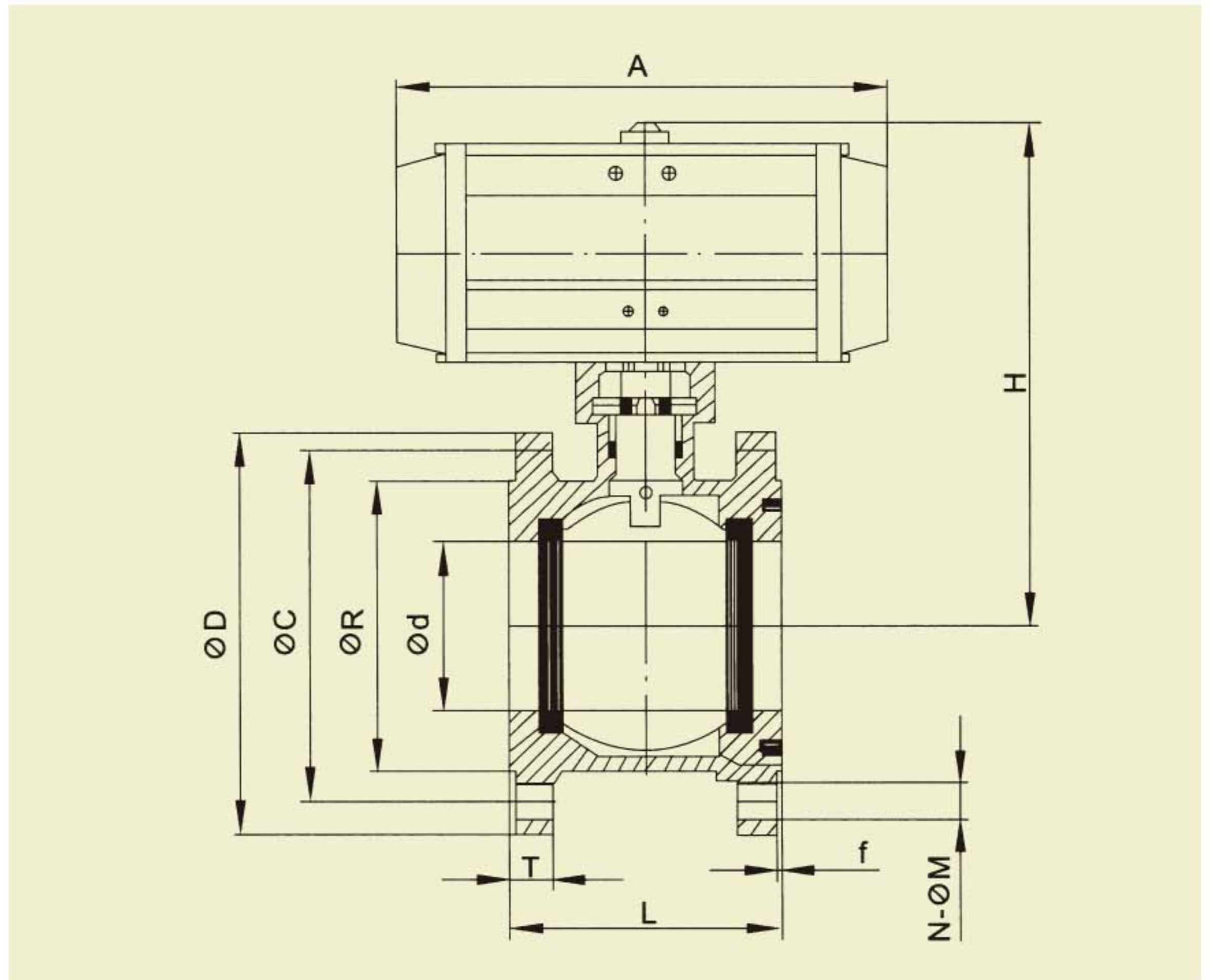

◆ 产品特征 SPECIFICATIONS

公称压力: 1.6~4.0Mpa

Working pressure: 1.6~4.0Mpa

适用温度范围: -20~232℃~350℃

Temperature range: -20~232℃~350℃

适用介质:

水、油、气及某些腐蚀性液体 (W.O.G)

Suitable medium:

Water, Oil, Air, and some corrosive Liquid

设计标准 (Design Standard):

GB/T12237/1989

连接法兰 (End Flange): JB79

防火测试 (Fire Safe):

API607 4th 1993

检验与测试 (Inspection & Testing):

GB/T13927-1992

规格 Specification	φd	φR	φc	φD	L	H	A	T	f	N-φM	执行器 Actuator	
DN15	1/2"	15	45	65	95	42	145	143	14	2	12	RAT052DA
DN20	3/4"	20	55	75	100	44	150	143	14	2	12	RAT052DA
DN25	1"	15	45	65	100	50	161	143	14	2	12	RAT052DA
DN32	1 1/4"	32	78	100	110	60	185	173	16	2	16	RAT063DA
DN40	1 1/2"	38	85	110	110	65	203	190	16	3	16	RAT075DA
DN50	2"	50	100	125	125	80	220	196.5	16	3	16	RAT083DA
DN65	2 1/2"	63.5	120	145	145	110	253	241	18	3	16	RAT092DA
DN80	3"	76	135	160	160	120	274	263.5	20	3	16	RAT105DA
DN100	4"	95	155	180	180	150	320	319	20	3	16	RAT125DA
DN125	5"	118	185	210	210	180	374	390	22	3	16	RAT140DA
DN150	6"	142	210	240	240	225	415	449	24	3	20	RAT160DA

序号 NO.	零件名称 PART	材质 MATERIAL			序号 NO.	零件名称 PART	材质 MATERIAL
1	阀体 Body	CF8M	CF8	WCB	12	碟簧 Butterfly spring	304
2	阀盖 Endcap	CF8M	CF8	WCB	13	螺母 Nut	304
3	球体 Ball	316	304		14	防松盖 Loose resistantcove	304
4	阀座 Ball Seat	PTFE	PPL		15	手柄螺母 Handle Nutr	304
5	阀杆 Stem	316	304	2Cr13	16	防位片 Lock Device	304
6	防静电装置 Anti-Static equipment	304			17	手柄 Handle	304
7	阀盖垫圈 Cap gasket	PTFE			18	手柄盖 Handle sleeve	塑料 Plastic
8	止推垫片 Thrust spacer	PTFE			19	定位螺栓 Stop Bol	304
9	填料 Filling	PTFE			20	锁紧螺栓 Set Screwedt	304
10	过渡垫片 Transitionspacer	增强聚四氟乙烯、柔性石墨			21	手柄 Handle	304
11	填料压环 Filling clampinging	304			22	板头 Handle Adapter	304