

# RF-395C DC MOTOR Series



Typical applications: TG-38(Φ37mm)、VFO (69.9X76.2mm)、PG-28(Φ28mm) planetary box.

## MOTOR TORQUE/SPEED/CURRENT

MOTOR MODEL	Rated Vol. V	No load		At maximum efficiency				Stall	
		Current mA	Speed r/min	Current mA	Speed r/min	Torque g·cm	Power W	Torque g·cm	Current mA
		RF-395CH-15140	24	≤ 60	7450	≤ 336	6420	90	5.8
RF-395CH-13160	24	≤ 60	6000	≤ 266	4910	77.3	4.07	420	1220
RF-395PA-17115	24	≤ 70	7200	≤ 370	6200	100	6.2	705	2500
RF-395PA-3082	12	≤ 150	7000	≤ 750	5885	97	5.85	609	3900

## APPEARANCE SIZE

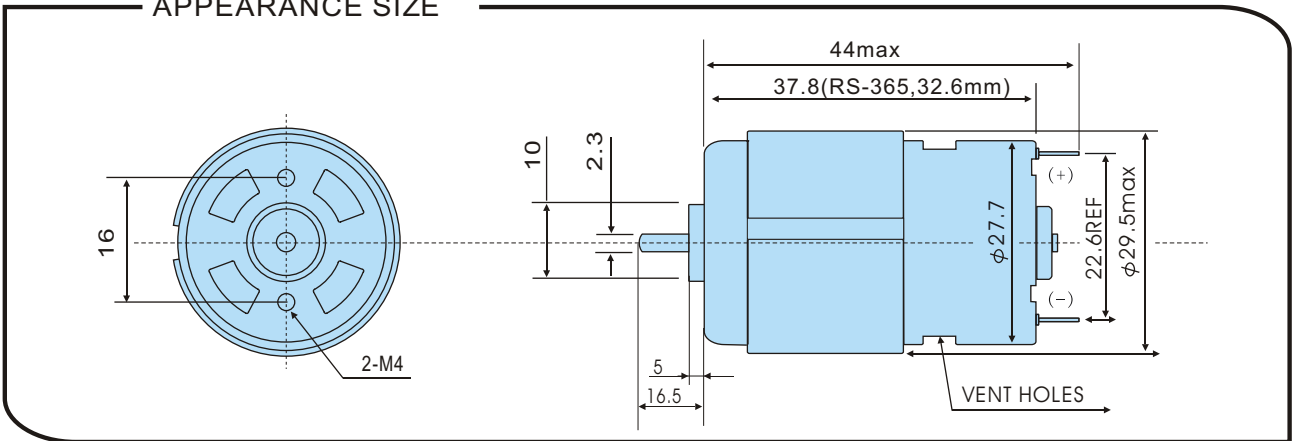

### RF-395CH-15140-24V CHARACTERISTICS

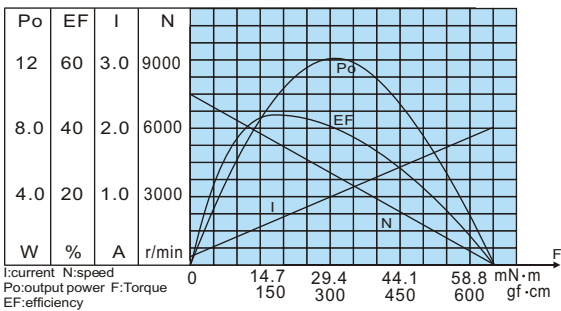

### RF-395CH-13160-24V CHARACTERISTICS

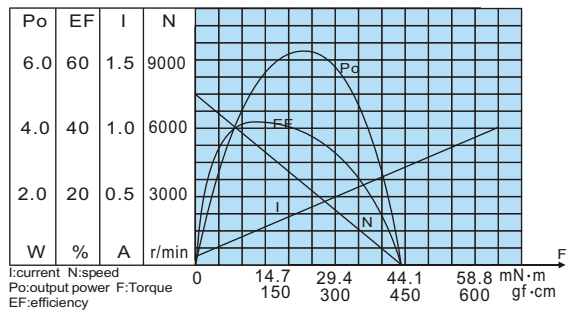

### RF-395CH-17115-24V CHARACTERISTICS

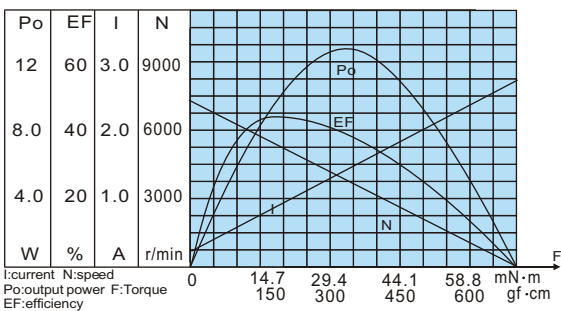

### RF-395CH-3082-12V CHARACTERISTICS

